

52 Flybridge

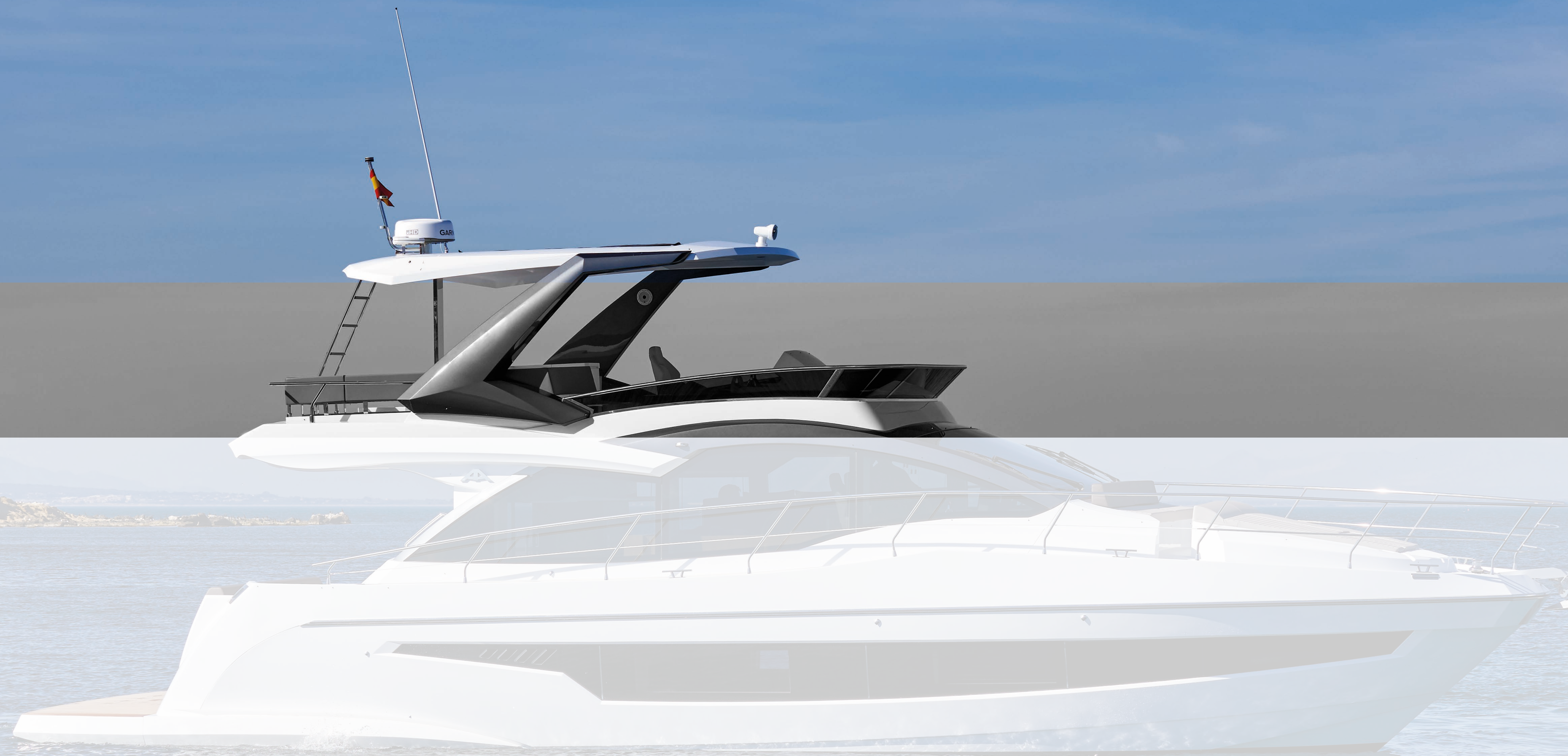

  
ASTONDOA







**The 66 Flybridge stands out for its liveability, comfort and high degree of personalisation as well as its ample freeboard that provides an internal volume that corresponds to that of a larger boat.**

**The trim in the form of a single window along the sides of the hull and the uncurved drop at the stern create a style that matches the latest contemporary designs for high-end yachts.**

El 66 Flybridge, destaca por su habitabilidad, su confort y su alto nivel de personalización así como por su notable francobordo, lo que le permite obtener unos volúmenes interiores propios de un barco de mayor eslora.

El ribete a modo de ventana única en las bandas del casco y su caída sin curvatura en su popa lo dotan de una estética que entronca con los diseños contemporáneos más recientes en el mundo de los yates de alta gama.























52 Flybridge |  
d e t a i l s







  
ASTONDOA





The 66 Flybridge boasts a high internal volume that corresponds to that of a larger boat.

El 66 Flybridge ofrece un gran volumen interior, con una capacidad de acomodación más propia de embarcaciones de esloras superiores.

  
ASTONDOA

















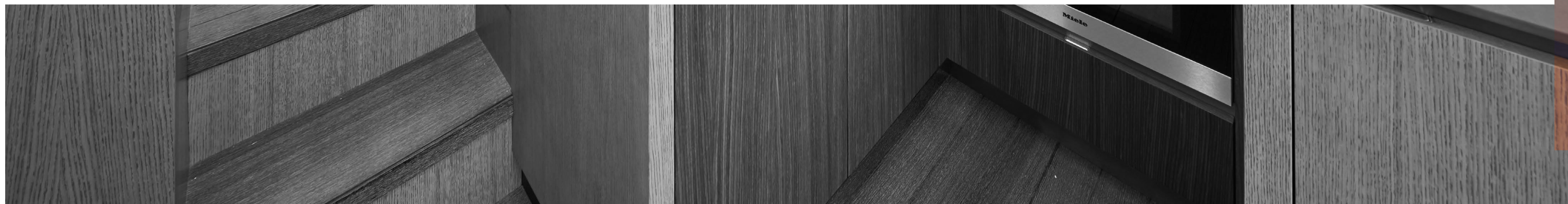



















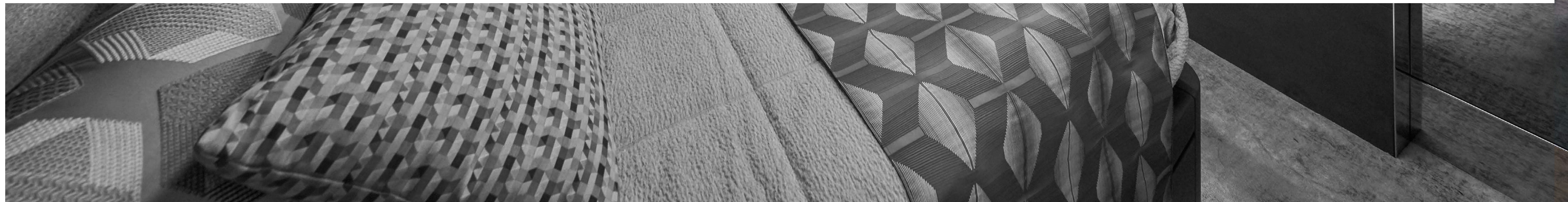
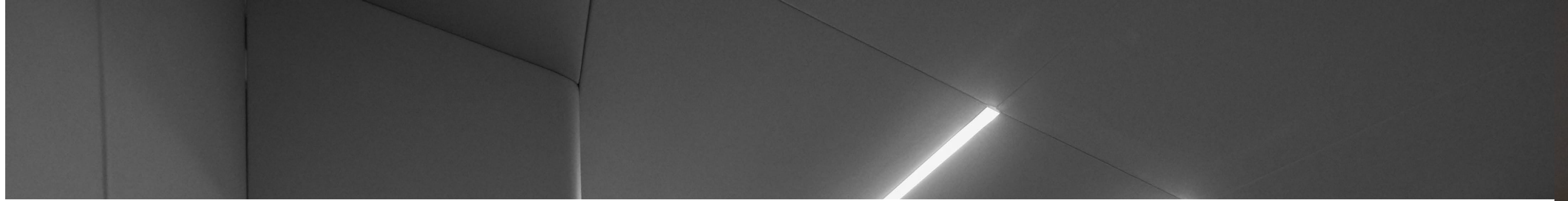





















  
ASTONDOA



  
ASTONDOA











# 52 Flybridge

## TECHNICAL DATA

### 1. ENGINES

Standard: 2 x VOLVO PENTA D11-725 (2 x 725 hp)

Opt.: 2 x MAN iS-730 (2 x 730 hp)

Opt.: 2 x VOLVO PENTA D8- IPS800 (2 x 600 hp)

### 2. SPEED\*

Max. speed: 30 kn

Cruising: 25 kn

### 4. MAIN SIZES

L.O.A. 16.00 m.

Beam 4,66 m.

Displacement 19 t.

Fuel 2.000 l.

Fresh water 420 l.

### 5. CHARACTERISTICS

Cabin: 3+3 heads (1 day head)

Building material GRP

Certified by RINA

\*Speed has been obtained at the following conditions: Standard version displacement, 10% load, four people on board, clean hull, good weather conditions. All dimensions, capacities and speeds are considered approximate. this information is indicative, not contractual. The shipyard may amend this information without notice

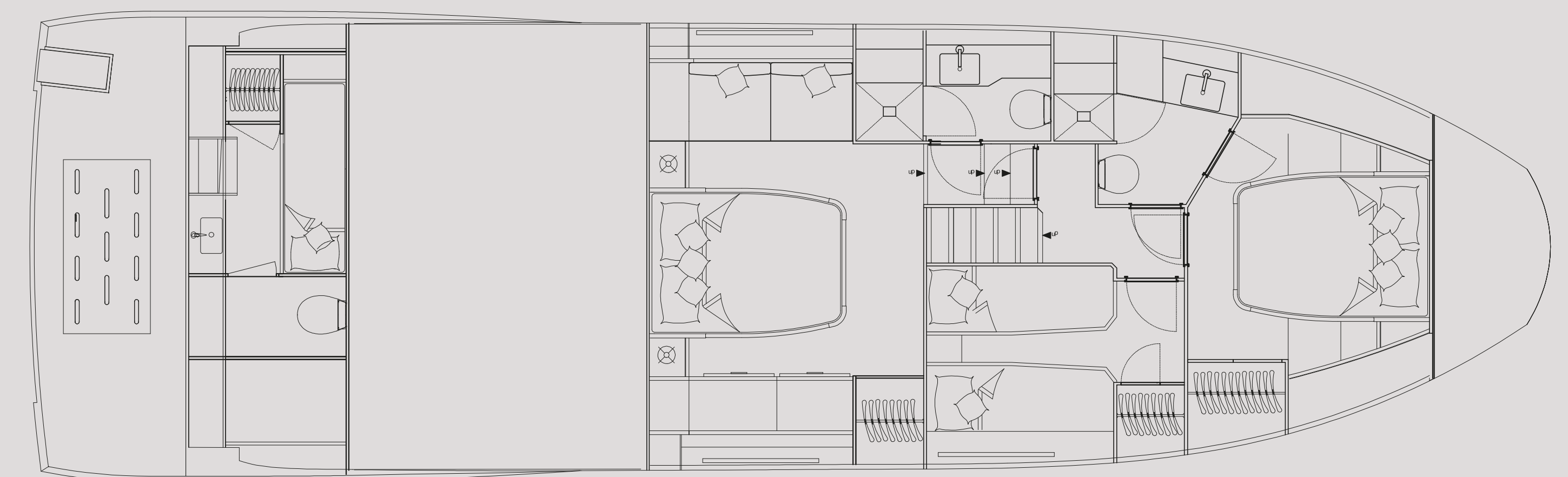
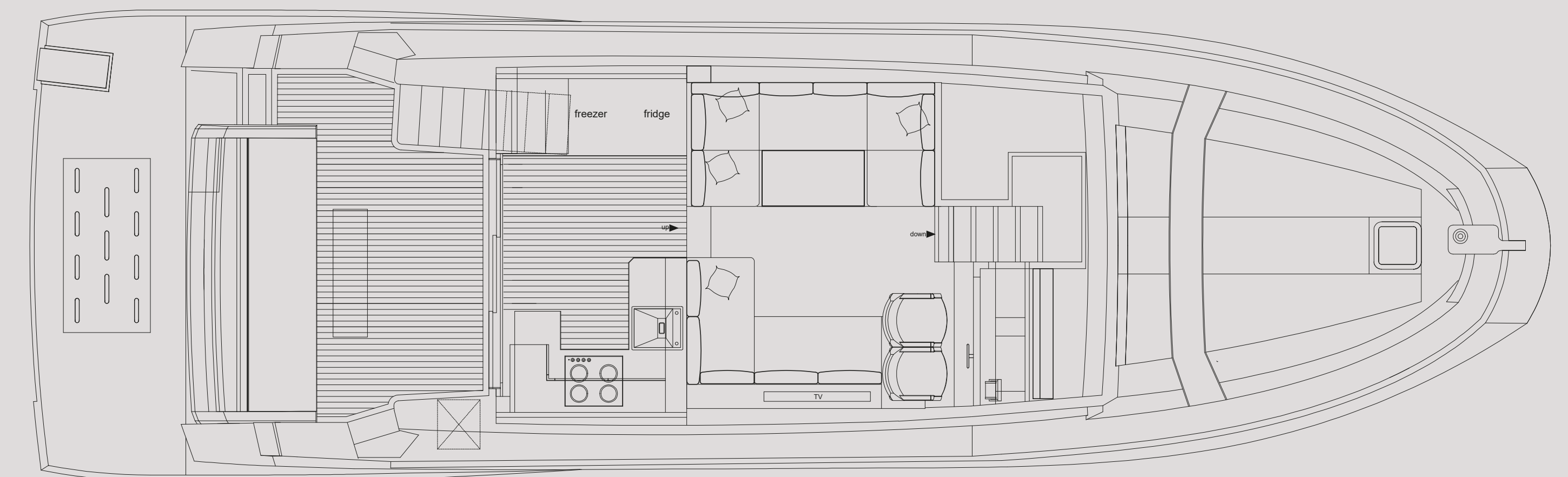
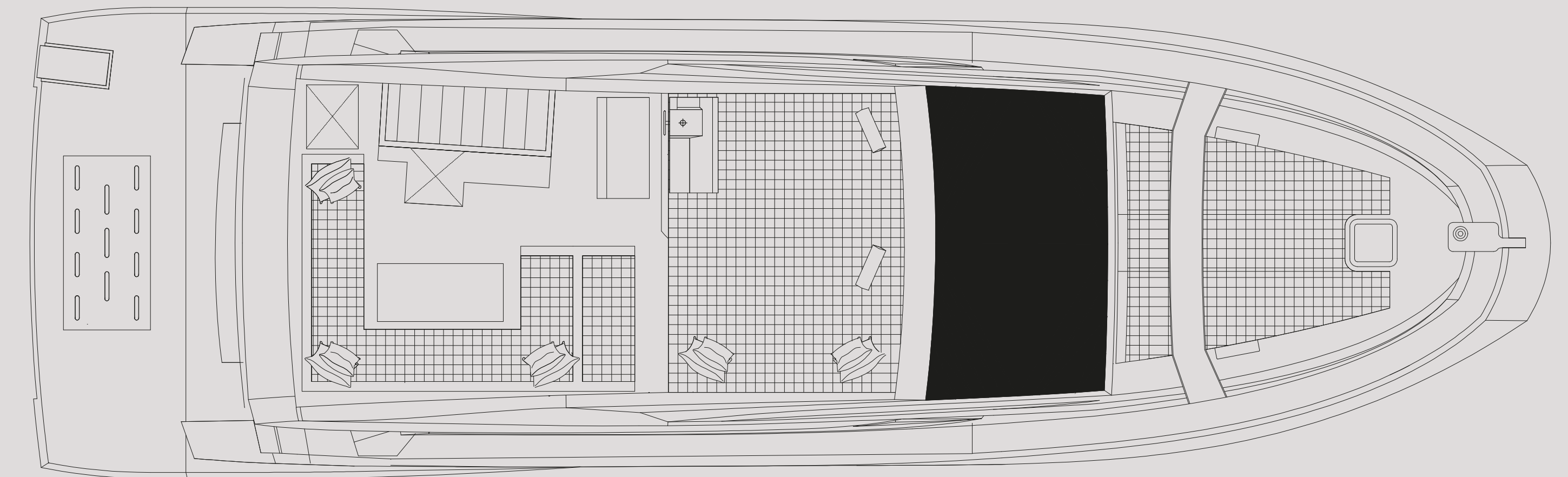
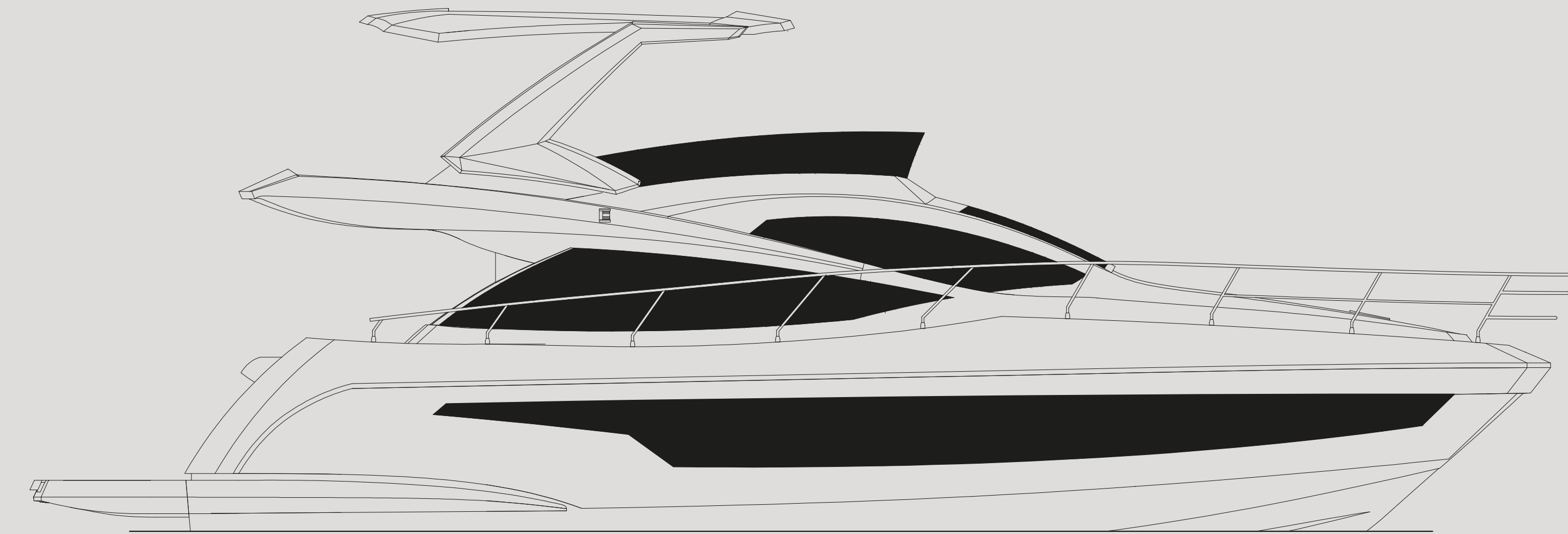





*52 Flybridge*